

# HI-LOW HYDRAULIC GEAR PUMP

PATENTED & REGISTERED DESIGN

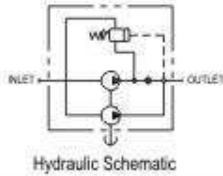

2 Stage High-Low hydraulic gear pump is the very ideal pump for applications which require a quick approach or return of the actuator at low loads and slow motion of the actuator at high loads. In particular this model offers the advantage of requiring lower power of the motor.

2 Stage High-Low hydraulic gears pump is a special double stage pump with special integrated valves (as shown in the hydraulic diagram) has been specially designed for applications such as trash compactors, log splitters, clamping mechanisms, crimping machines, metal forming machines etc.

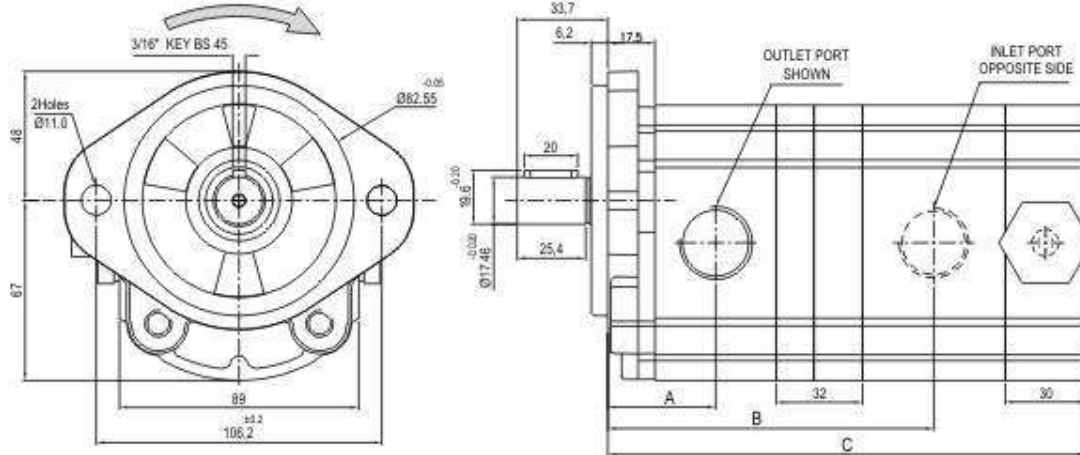

## PUMP SELECTION GUIDE

PUMP NO.	DIMENSIONS			SPECIFICATION DATA				
	A	B	C	NOMINAL FLOW L/MIN	HIGH PRESSURE L/MIN	LOW PRESSURE L/MIN	INLET	OUTLET
HL 0612	40.50	122.00	178.50	18	06	12	3/4" BSP	3/4" BSP
HL 0716	41.00	124.50	182.50	23	07	16	3/4" BSP	3/4" BSP
HL 0920	42.50	130.00	190.50	29	09	20	1" BSP	3/4" BSP
HL 1223	44.00	134.50	196.50	35	12	23	1" BSP	3/4" BSP
HL 1632	45.50	147.00	218.50	48	16	32	1" BSP	1" BSP
HL 2040	48.00	157.00	233.50	60	20	40	1" BSP	1" BSP

NOTE : - All pumps above are 3000 psi Max. working pressure.

- 340-1000 psi unload adjustable range, and 500-4000 RPM range.

- All pumps factory present at 600 psi at 1500 rpm.

- For setting outside range, please contact our factory.

## PERFORMANCE CURVES (1500 RPM)

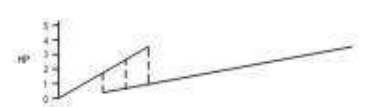

HL 0612

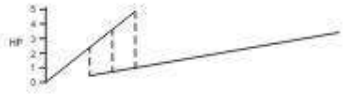

HL 0716

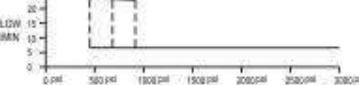

HL 0920

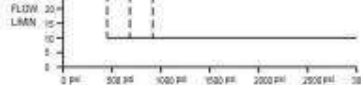

HL 1223

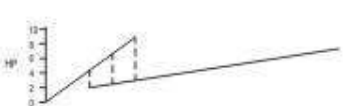
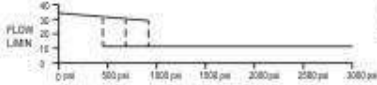

HL 1632

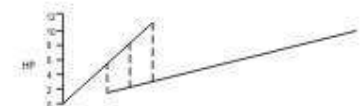
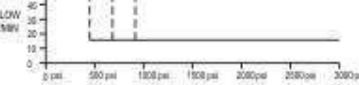

HL 2040

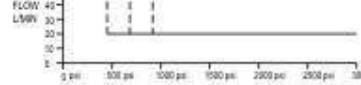

1, Yadav Estate, G.D. School Road, Saijpur, Ahmedabad-382345, INDIA  
 Tel : +91-79-22818120 Fax : +91-79-22801560 Cell : +91-9824011542  
 Email : bhavesh@vbchyd.com www.vbchyd.com, hydraulicgearpumps.com